



# MetroWest+

## Portishead Branch Line (MetroWest Phase 1)

TR040011

**Applicant: North Somerset District Council**

**2.32 – Crossings to be Extinguished Plans**

**The Infrastructure Planning (Applications: Prescribed Forms and Procedure) Regulations 2009, regulation 5(2)(o)  
Planning Act 2008**

**Author: CH2M**

**Date: November 2019**



## Document Index

2.32	Crossings to be Extinguished Plans	The Infrastructure Planning (Applications: Prescribed Forms and Procedure) Regulations 2009, regulation 5(2)(o)	674946.BQ.42.01-410-415 and 674946.BQ.42.01-426 Rev E
------	------------------------------------	---	---

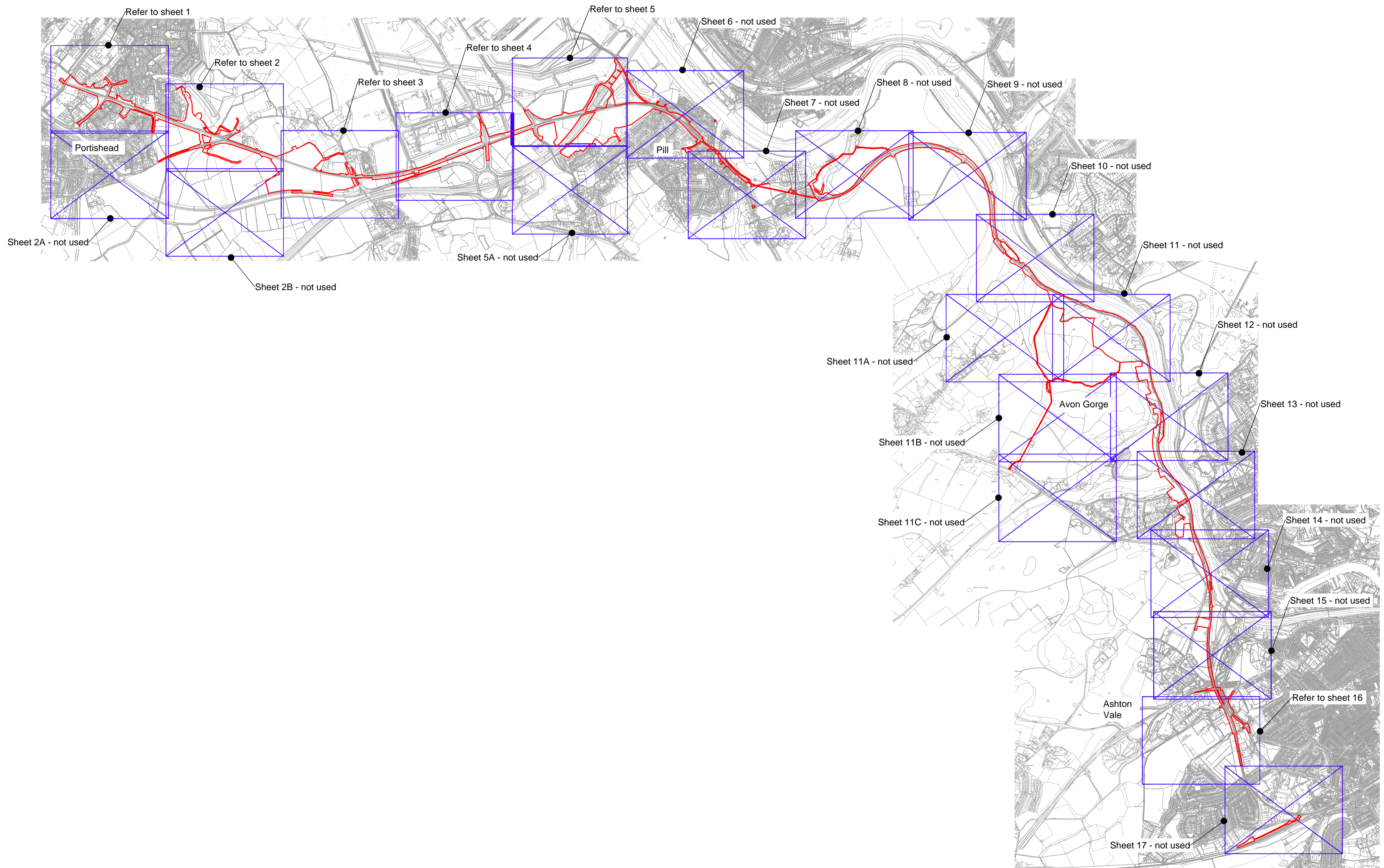
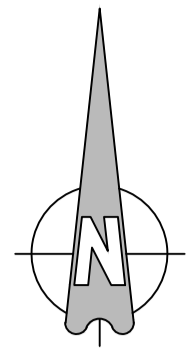

Key:  
— Order Limits

E	FG	ADL	ADL	11/10/19
Rail Line and Crossings Updated				
D	OHP	KS	ADL	12/06/2019
Minor Amendments				
C	FG	KS	ADL	01/07/2019
Rail Line and Closures Updated				
B	FG	KS	ADL	18/04/2019
Rail Line Updates and Level Crossing References Added				
A	FG	KS	ADL	15/01/2019
First Issue				
Rev	By	Check	Approved	Date
Description				



**CH2M HILL**  
 1 The Square Temple Quay Bristol  
 BS1 6DG  
 Tel +44 (0)117 910 2580  
 Fax +44 (0)117 910 2581  
 www.ch2m.com



Project  
 THE PORTISHEAD BRANCH LINE  
 (METROWEST PHASE 1)  
 ORDER

Drawings  
**CROSSINGS  
 TO BE EXTINGUISHED  
 SHEET 0  
 KEY PLAN**

Drawn by	FG	Check	ADL	Date	15/01/2019
Created by	KS	Check	ADL	Date	15/01/2019
Approved by	ADL	Check	ADL	Date	15/01/2019

674946.BQ.42.01-410 | E  
 Drawing Scale: 1:32000 @ A3

This map is reproduced from Ordnance Survey material by CH2M on behalf of North Somerset Council with the permission of the Controller of Her Majesty's Stationary Office, © Crown copyright. Unauthorised reproduction infringes Crown copyright and may lead to prosecution or civil proceedings. Licence Number: 10002339

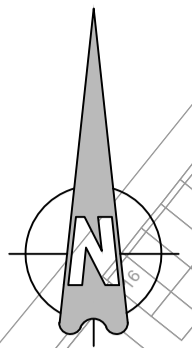

**Key:**

- Order Limits
- Level crossing to be extinguished
- Temporary Diversion (Indicative Route)

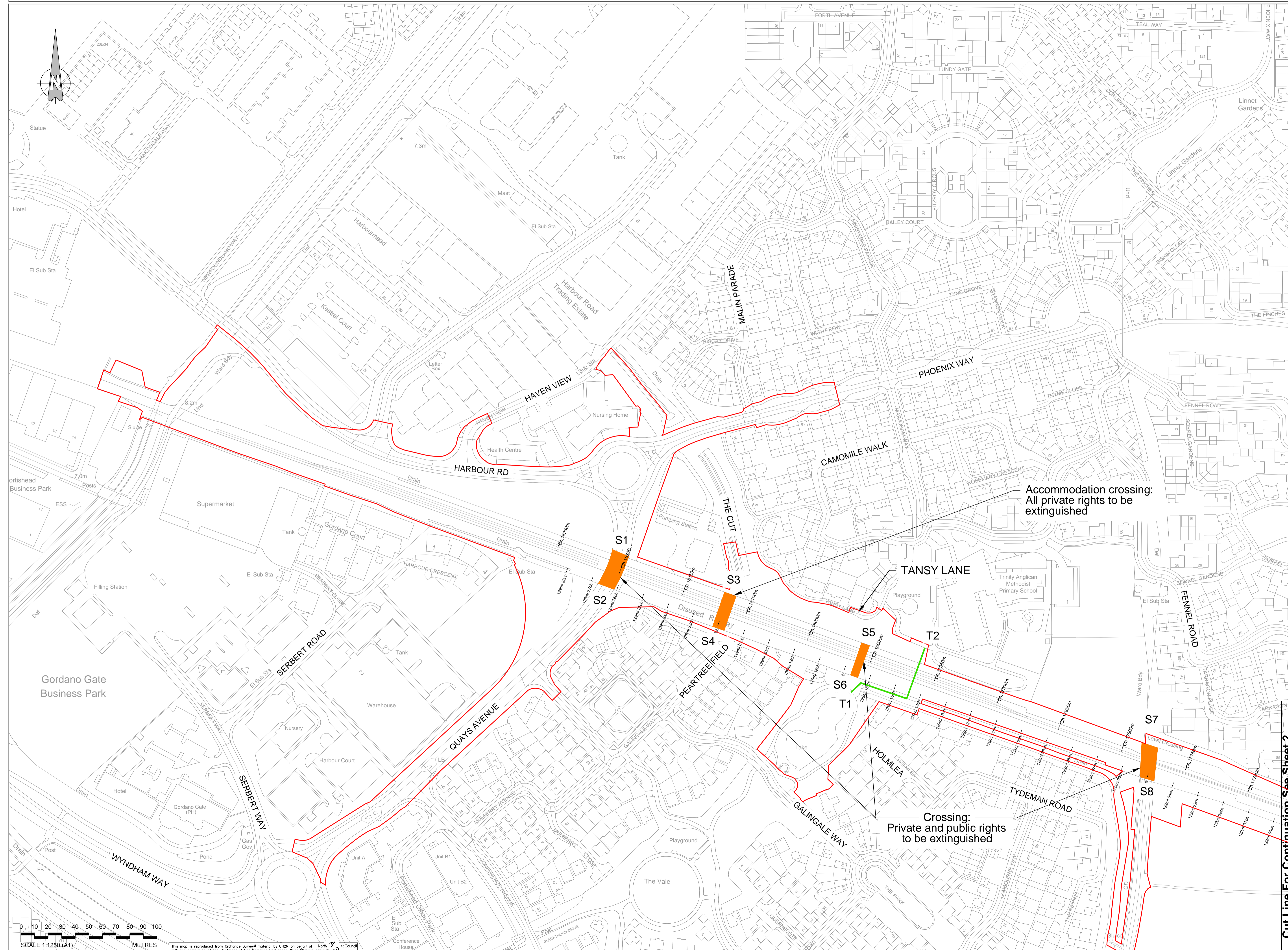

Accommodation crossing:  
All private rights to be extinguished

Crossing:  
Private and public rights  
to be extinguished

Rev	By	Check	Appr'd	Date	Description
E	FG	ADL	ADL	11/10/19	Red Line and Crossings Updated
D	QHP	KS	ADL	12/06/19	Minor Amendments
C	FG	KS	ADL	01/07/19	Red Line and Crossings Updated
B	FG	KS	ADL	18/04/19	Red Line Updated and Level Crossing References Added
A	FG	KS	ADL	15/01/19	First Issue

**travelwest+**

**CH2M HILL**  
1 The Square Temple Quay Bristol  
BS1 6DG  
Tel +44 (0)117 910 2580  
Fax +44 (0)117 910 2581  
www.ch2m.com

**ch2m**

THE PORTISHEAD BRANCH LINE  
(METROWEST PHASE 1)  
ORDER

CROSSINGS  
TO BE EXTINGUISHED  
SHEET 1  
PORTISHEAD

674946.BQ.42.01-411 E  
Scale: 1:2500 @ A3

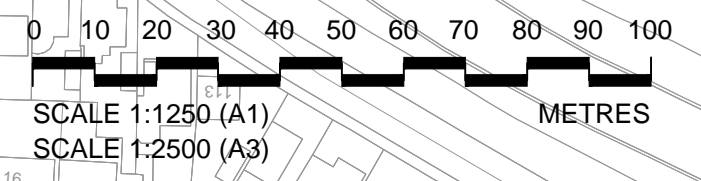

This map is reproduced from Ordnance Survey material by CH2M on behalf of North with the permission of the Controller of Her Majesty's Stationery Office, © Crown copyright. Unauthorised reproduction infringes Crown copyright and may lead to prosecution or civil litigation. Licence Number: 10002339

Cut Line For Continuation See Sheet 2

- Key:**
- Order Limits
  - Level crossing to be extinguished
  - Improvements to agricultural access

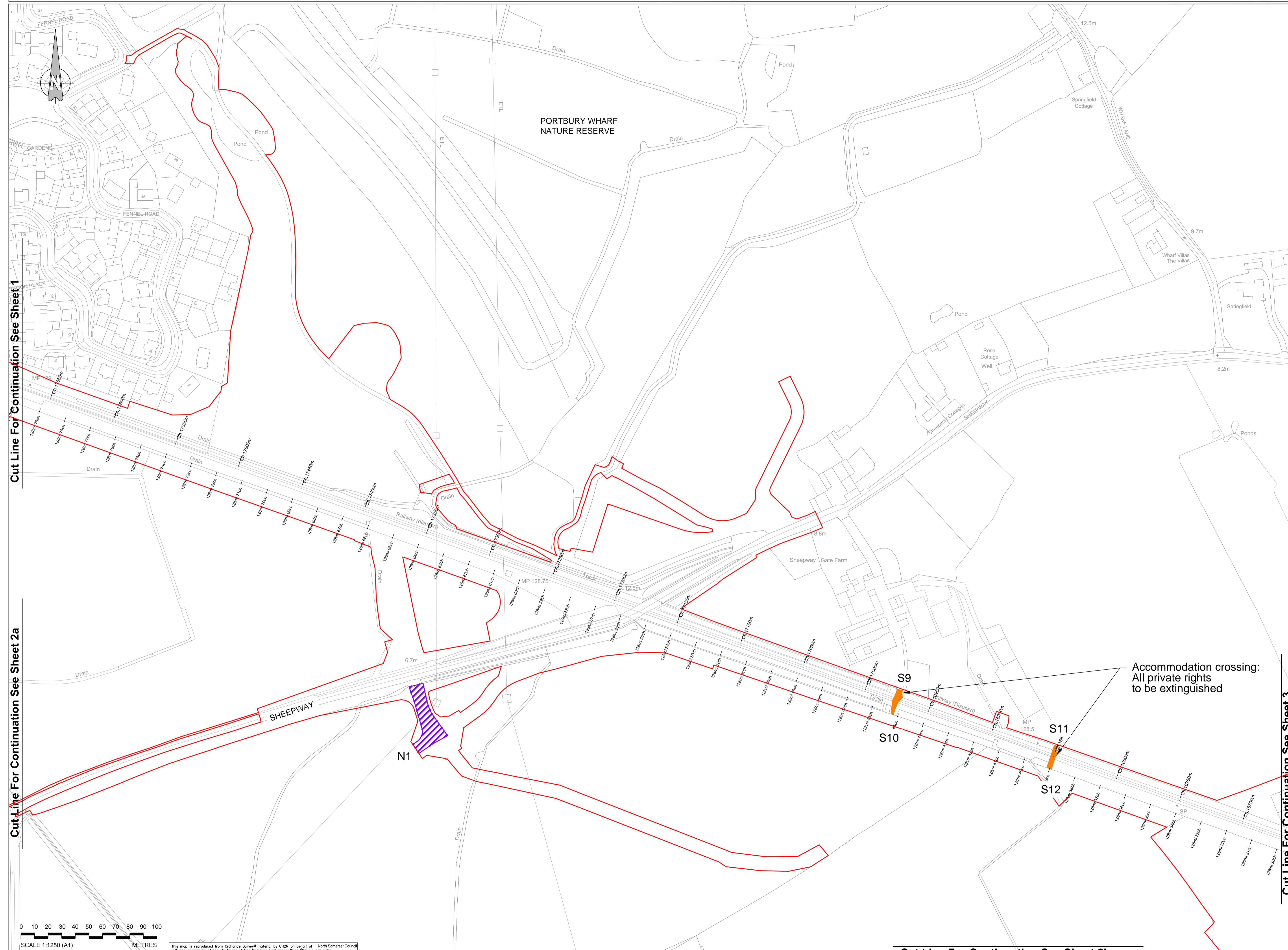

Cut Line For Continuation See Sheet 1

Cut Line For Continuation See Sheet 2a

Cut Line For Continuation See Sheet 3

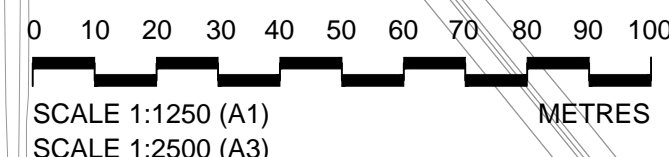

This map is reproduced from Ordnance Survey material by CH2M on behalf of North Somerset Council with the permission of the Controller of Her Majesty's Stationary Office, © Crown copyright. Unauthorised reproduction infringes Crown copyright and may lead to prosecution or civil proceedings. Licence Number: 10002339

Cut Line For Continuation See Sheet 2b

Accommodation crossing:  
All private rights  
to be extinguished

E	FG	ADL	ADL	11/10/19
Rail Line and Crossings Updated				
D	OHP	KS	ADL	12/06/2019
Minor Amendments				
C	FG	KS	ADL	31/01/2019
Rail Line and Closures Updated				
B	FG	KS	ADL	18/04/2019
Rail Line Updated and Level Crossing References Added				
A	FG	KS	ADL	15/01/2019
Final Issue				
Rev	By	Check	Approved	Date
Description				

**travelwest**  
 CH2M HILL  
 1 The Square Temple Quay Bristol  
 BS1 6DG  
 Tel +44 (0)117 910 2580  
 Fax +44 (0)117 910 2581  
 www.ch2m.com

**ch2m**

Project  
 THE PORTISHEAD BRANCH LINE  
 (METROWEST PHASE 1)  
 ORDER

Drawings  
 CROSSINGS  
 TO BE EXTINGUISHED  
 SHEET 2  
 SHEEPWAY

Checked by: FG Date: 15/01/2019  
 Drawn by: KS Date: 15/01/2019  
 Approved by: ADL Date: 15/01/2019

674946.BQ.42.01-412 E  
 Drawing Scale: 1:2500 @ A3

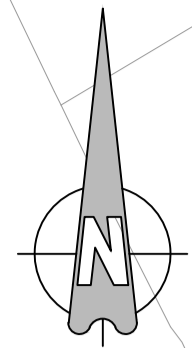

**Key:**

- Order Limits
- Level crossing to be extinguished
- New Access

Cut Line For Continuation See Sheet 2

Cut Line For Continuation See Sheet 4

Occupation crossing:  
All private rights  
to be extinguished

Accommodation crossing:  
All private rights to be  
extinguished

THE PORTBURY HUNDRED  
CONSTRUCTION COMPOUND

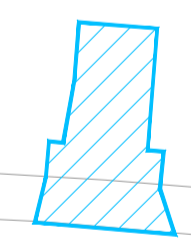

A369 THE PORTBURY HUNDRED

STATION ROAD

Old Portbury Station

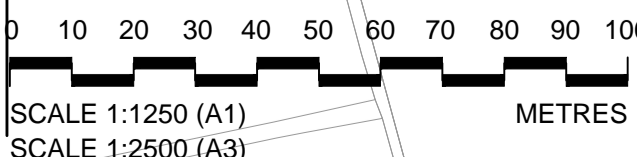

This map is reproduced from Ordnance Survey material by CH2M on behalf of North Somerset Council with the permission of the Controller of Her Majesty's Stationery Office. © Crown copyright. Unauthorised reproduction infringes Crown copyright and may lead to prosecution or civil proceedings. Licence Number: 100023397

E	FG	ADL	ADL	11/10/19
Rail Line and Crossings Updated				
D	QHP	KS	ADL	12/06/2019
Minor Amendments				
C	FG	KS	ADL	31/01/2019
Rail Line and Closures Updated				
B	FG	KS	ADL	18/04/2019
Rail Line Updates and Level Crossing References Added				
A	FG	KS	ADL	15/01/2019
Final Issue				
Rev	By	Check	Approved	Date
Description				

**travelwest**  
 CH2M HILL  
 1 The Square Temple Quay Bristol  
 BS1 6DG  
 Tel +44 (0)117 910 2580  
 Fax +44 (0)117 910 2581  
 www.ch2m.com



**ch2m**

Project  
**THE PORTISHEAD BRANCH LINE  
 (METROWEST PHASE 1)  
 ORDER**

Sheet  
**CROSSINGS  
 TO BE EXTINGUISHED  
 SHEET 3  
 OLD PORTBURY STATION**

Checked by: FG	Date: 15/01/2019
Drawn by: KS	Date: 15/01/2019
Approved by: ADL	Date: 15/01/2019

674946.BQ.42.01-413 E  
 Drawing Scale: 1:2500 @ A3

Key:  
 Order Limits  
 Level crossing to be extinguished

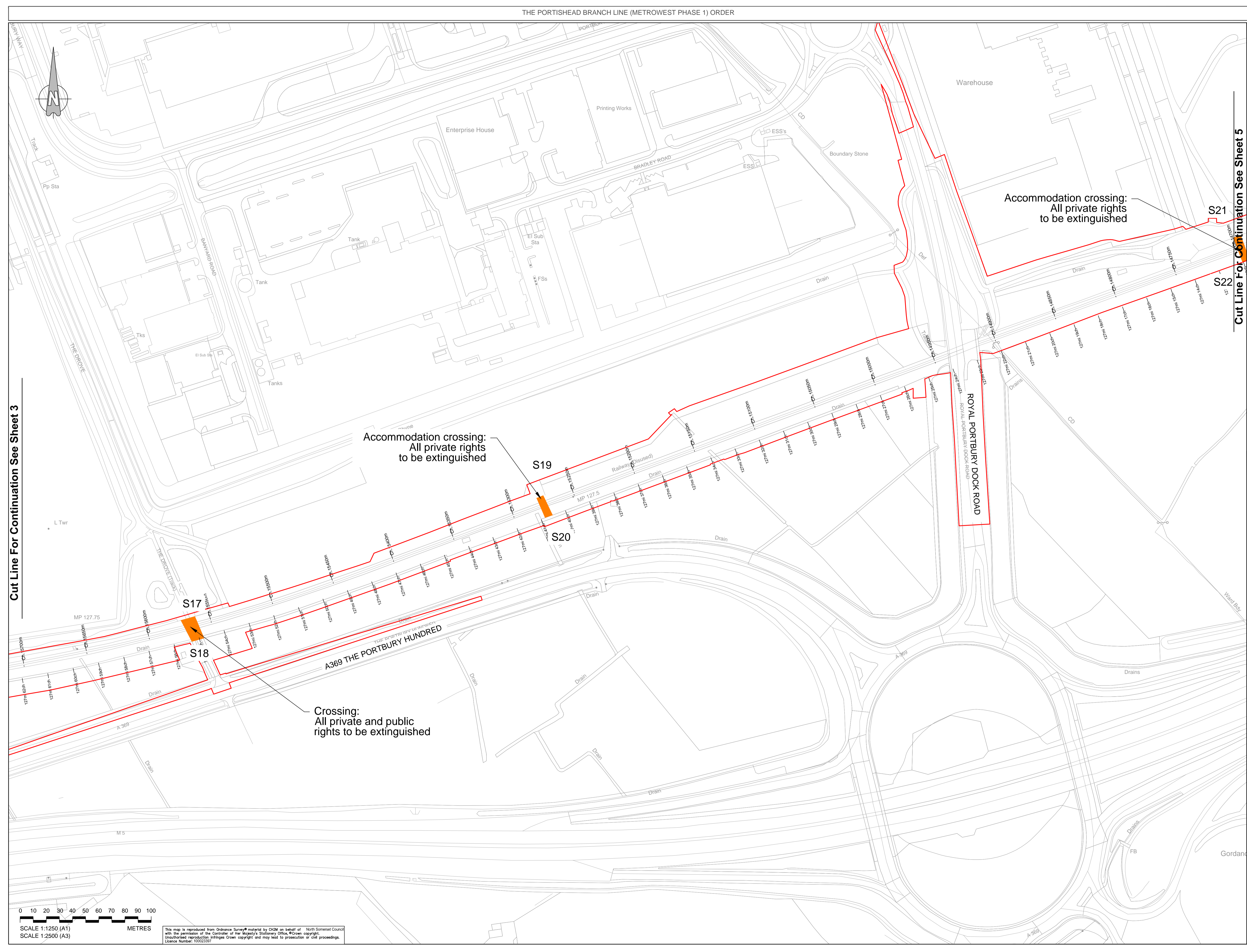

Cut Line For Continuation See Sheet 3

Cut Line For Continuation See Sheet 5

E	FG	ADL	ADL	11/10/19
Red Line and Crossings Updated				
D	OHP	KS	ADL	12/06/2019
Minor Amendments				
C	FG	KS	ADL	31/01/2019
Red Line and Closures Updated				
B	FG	KS	ADL	18/04/2019
Red Line Updated and Level Crossing References Added				
A	FG	KS	ADL	15/01/2019
Final Issue				
Rev	By	Check	Approved	Date
Description				

travelwest+  
 CH2M HILL

1 The Square Temple Quay Bristol  
 BS1 6DG  
 Tel +44 (0)117 910 2580  
 Fax +44 (0)117 910 2581  
 www.ch2m.com

ch2m

THE PORTISHEAD BRANCH LINE  
 (METROWEST PHASE 1)  
 ORDER

CROSSINGS  
 TO BE EXTINGUISHED  
 SHEET 4  
 JUNCTION 19

Scale: FG 1:1250 (A1) Date: 15/01/2019  
 Scale: KS 1:2500 (A3) Date: 15/01/2019  
 Scale: ADL 1:2500 (A3) Date: 15/01/2019  
 674946.BQ.42.01-414 E  
 Drawing Scale: 1:2500 @ A3

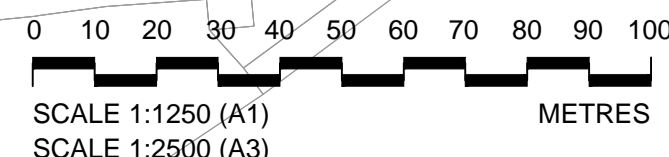

This map is reproduced from Ordnance Survey material by CH2M on behalf of North Somerset Council with the permission of the Controller of Her Majesty's Stationary Office, © Crown copyright. Unauthorised reproduction infringes Crown copyright and may lead to prosecution or civil proceedings. Licence Number: 10002339

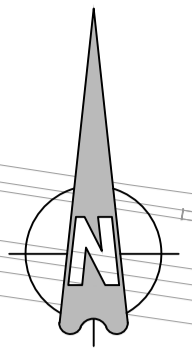

**Key:**  
— Order Limits  
 Level crossing to be extinguished

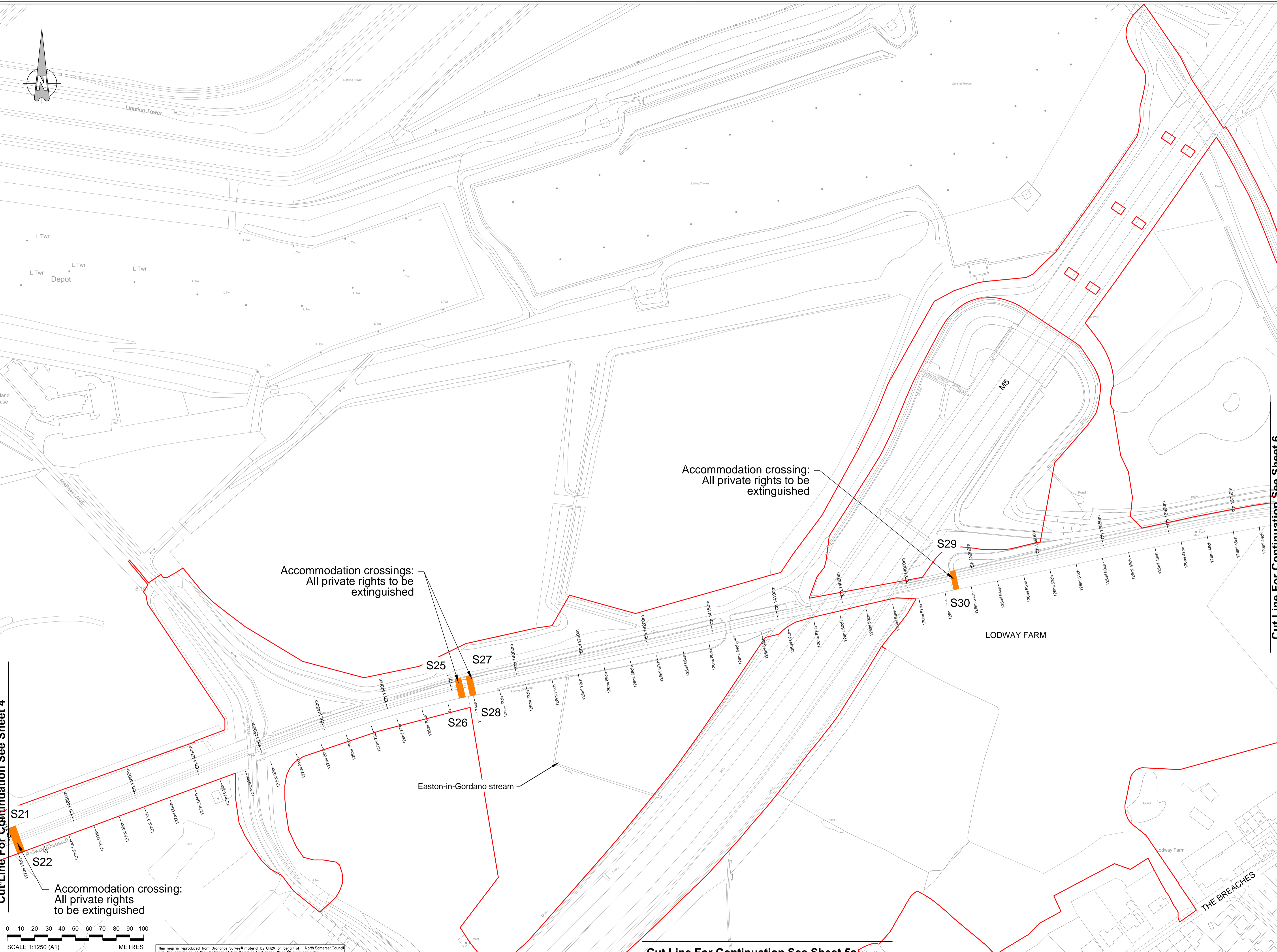

Cut Line For Continuation See Sheet 4

Cut Line For Continuation See Sheet 6

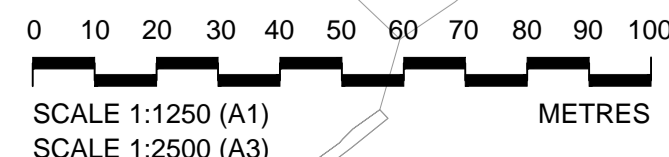

This map is reproduced from Ordnance Survey material by CH2M on behalf of North Somerset Council with the permission of the Controller of Her Majesty's Stationary Office, © Crown copyright. Unauthorised reproduction infringes Crown copyright and may lead to prosecution or civil proceedings. Licence Number: 100023397

E	FG	ADL	ADL	11/10/19
Ref Line and Crossings Updated				
D	OHP	KS	ADL	12/06/2019
Minor Amendments				
C	FG	KS	ADL	31/07/2019
Ref Line and Closures Updated				
B	FG	KS	ADL	18/04/2019
Ref Line Updated and Level Crossing References Added				
A	FG	KS	ADL	15/07/2019
First Issue				
Rev	By	Check	Approved	Date
Description				

**travelwest**  
 CH2M HILL  
 1 The Square Temple Quay Bristol  
 BS1 6DG  
 Tel +44 (0)117 910 2580  
 Fax +44 (0)117 910 2581  
 www.ch2m.com

**ch2m**

Project: THE PORTISHEAD BRANCH LINE (METROWEST PHASE 1) ORDER  
 Sheet: CROSSINGS TO BE EXTINGUISHED SHEET 5 M5 OVERBRIDGE  
 Date: 15/07/2019  
 Checked by: KS  
 Approved by: ADL  
 Drawing Title: 1:2500 @ A3

Cut Line For Continuation See Sheet 5a



**Cut Line For Continuation See Sheet 15**

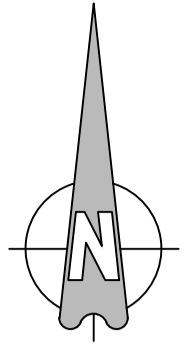

**Key:**

- Order Limits
- Level crossing to be extinguished

Barons Close footpath crossing to be closed

S31

S32

BARONS CLOSE

WINTERSTOKE ROAD

ALDERMAN MOORE'S ALLOTMENT

ASHTON VALE

**Cut Line For Continuation See Sheet 17**

E	FG	ADL	ADL	11/10/19
Ret Line and Crossings Updated				
D	OHP	KS	ADL	12/06/2019
Minor Amendments				
C	FG	KS	ADL	31/01/2019
Ret Line and Closures Updated				
B	FG	KS	ADL	18/04/2019
Ret Line Updated and Level Crossing References Added				
A	FG	KS	ADL	15/01/2019
Final Issue				
Rev	By	Check	Approved	Date
Description				

**travelwest+**  
Travelwest is a registered trademark of Travelwest Group Limited. All rights reserved.

**CH2M HILL**  
 1 The Square Temple Quay Bristol  
 BS1 6DG  
 Tel +44 (0)117 910 2580  
 Fax +44 (0)117 910 2581  
 www.ch2m.com



Project: THE PORTISHEAD BRANCH LINE (METROWEST PHASE 1) ORDER

Drawings: CROSSINGS TO BE EXTINGUISHED SHEET 16 ASHTON VALE

Checked:	FG	Date:	15/01/2019
Created:	KS	Date:	15/01/2019
Approved:	ADL	Date:	15/01/2019
Drawing:	674946.BQ.42.01-426	Sheet:	E
Scale:	1:2500 @ A3		

0 10 20 30 40 50 60 70 80 90 100 METRES

SCALE 1:1250 (A1)  
 SCALE 1:2500 (A3)

This map is reproduced from Ordnance Survey material by CH2M on behalf of North Somerset Council with the permission of the Controller of Her Majesty's Stationery Office. © Crown copyright. Unauthorised reproduction infringes Crown copyright and may lead to prosecution or civil proceedings. Licence Number: 10002339